

# FOX POINT

files



by Douglas H. Frazer

## The Shape of Things: Fox Point Boundaries

Part One

**FOX POINT'S** boundaries have an interesting history. To appreciate that history, we must begin long before area electors incorporated the village in 1926.

The Town of Milwaukee (Town), created in 1835, originally embraced 144 square miles, including all of Milwaukee County north of Greenfield Avenue. Over time, this territory was subdivided into other unincorporated townships or newly incorporated municipalities: The City of Milwaukee (City) in 1846, and to the north near Lake Michigan, Whitefish Bay in 1892, Shorewood (originally known as East Milwaukee) in 1900, Fox Point in 1926, River Hills in 1930, and the City of Glendale in 1950.

At the time of Glendale's incorporation, the City occupied only 23 percent of Milwaukee County's 241 square miles. Seven townships, including what remained of the Town, governed 61 percent of the county.

These seven townships, including the Town, would soon disappear. Between 1950 and 1957, boundary wars arose among the City and bordering municipalities and the would-be organizers of new municipalities.

In 1950, Fox Point's boundaries had not much changed since incorporation. The southern boundary was School Road, its eastern boundary Lake Michigan, its northern boundary extending west in a survey line from the lake beginning just north of Dean Road to a point 300 feet west of North Regent Road, then straight south to the survey line extending west from School Road.

Glendale's south side, from just north of Capitol Drive, was largely industrial. The residential portion of Glendale reached northward, and touched Fox Point at, a segment of Daphne Road east of Port Washington Road.

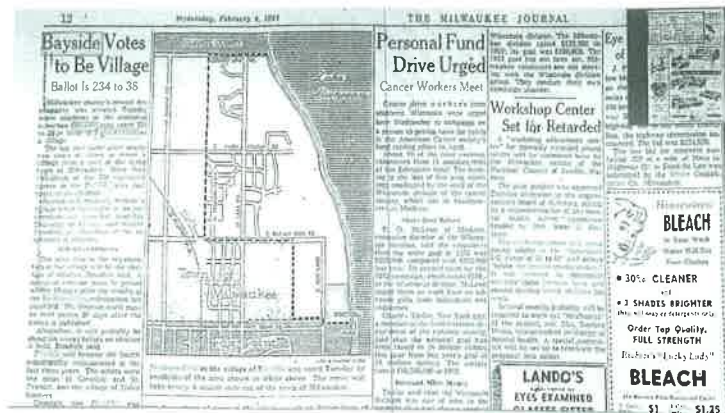

Bayside Votes to be a Village 02/04/1953

Still within the Town were the residents and property owners within a few miles of the intersection of Port Washington and Brown Deer Roads.

On February 3, 1953, Bayside area residents voted 231-36 to incorporate. The newly minted village included, from the east, the area north of the Fox Point boundary to the county line, west to a survey line just beyond Pelham Parkway, south to Brown Deer Road, west to a point about 1200 feet east of Lake Drive, and south back to the boundary with Fox Point. Bayside took nearly a square mile out of the Town, leaving the Town only 3.5 square miles and precious few residents—not nearly enough to support itself as an independent unit of government.

Fox Point, Bayside, River Hills, and Glendale had the answer: annexation.

Annexation is the method of transferring unincorporated territory situated in towns to incorporated cities and villages. Property owners or residents can seek annexation through the filing of a petition. A successful annexation petition often requires a gerrymandered territory—for

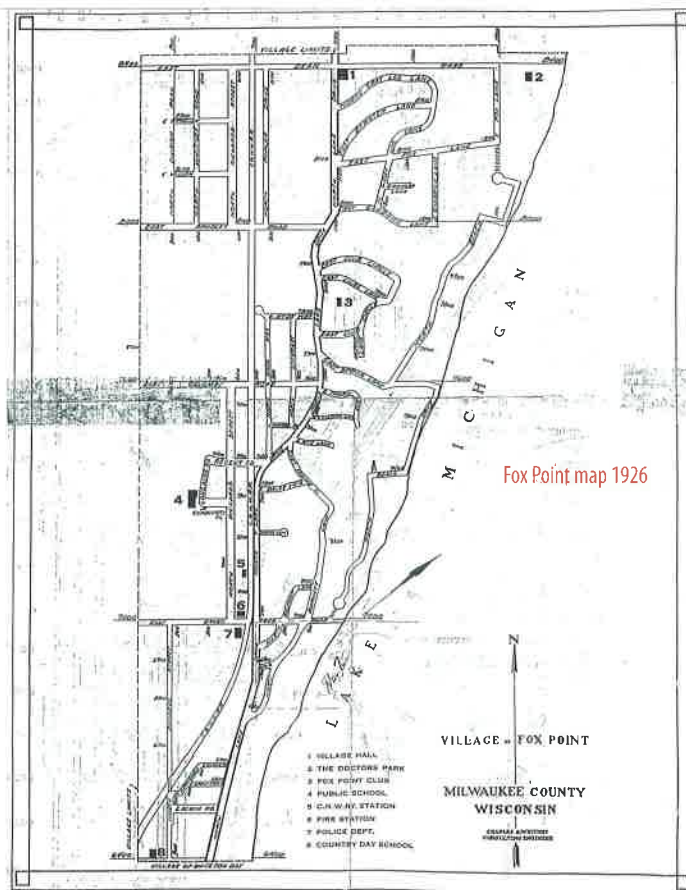

Fox Point map 1926

**(Abracadabra)**  
**Furniture Restoration**  
 Wood Refinishing • Upholstery • Antique Restoration • Caning  
 1000's of Fabrics to choose from! Recommended by Designers  
**262.387.0435 • Free Estimates**  
 8-4 Mon.-Fri., Evenings & Sat. by Appointment  
 1507 7th Ave • Grafton, WI 53024  
[abracadabra-wood.com](http://abracadabra-wood.com)

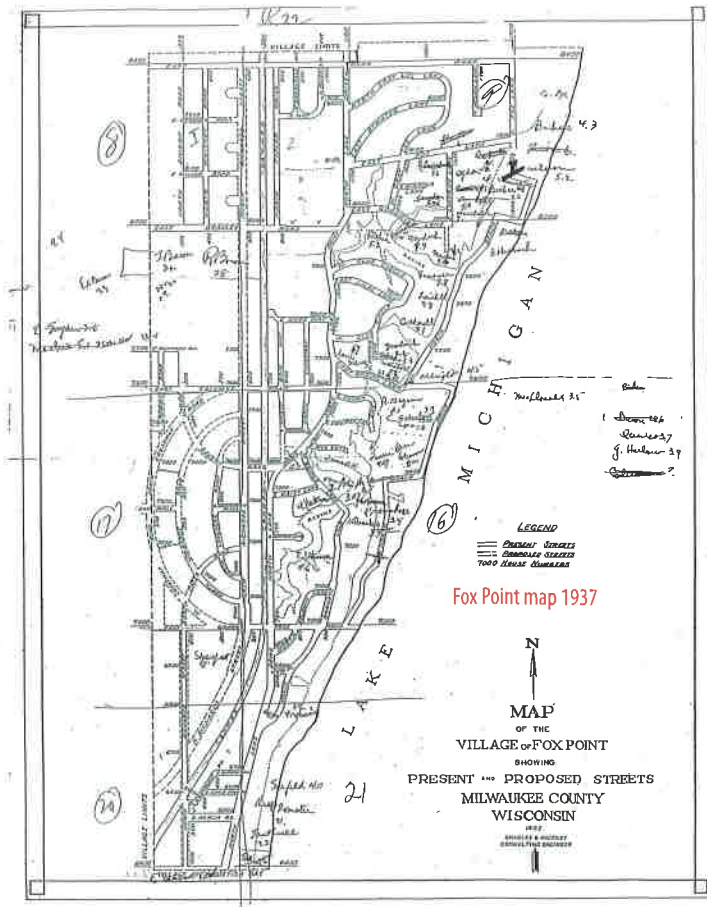

Fox Point map 1937

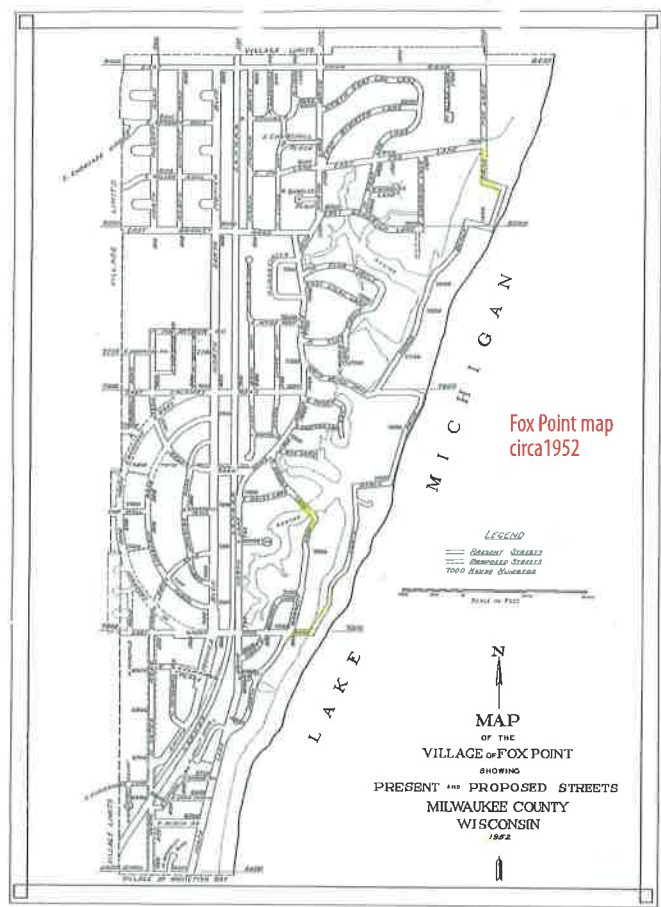

Fox Point map circa 1952

the law mandated (and still mandates) written consent of (a) one-half of the territory's qualified electors *and* (b) one-half of the property owners (measured by area or assessed value).

The governing body of the municipality then needs to adopt an annexation ordinance by a two-thirds vote of the elected members.

Richard Cutler, a prominent attorney, Fox Point resident, and a 41-year member of the Village Plan Commission, was an important player in these annexation fights. Cutler covers the subject in his book *Greater Milwaukee's Growing Pains, 1950-2000: An Insider's View* (Milwaukee County Historical Society 2001).

Glendale had designs to annex what remained of the Town. This alarmed Fox Point, River Hills, and Bayside. Residents of these villages believed Glendale might permit incompatible commercial and industrial development in adjoining areas. For example, rumor had it that Jimmy Fazio's Supper Club, a popular but noisy restaurant and entertainment venue at 5743 N. Port Washington Road, was poised to move north to a vacant corner at Port Washington Road and Bradley.

Fox Point's efforts to counter Glendale's march to the northeast was about to move into high gear.

*Douglas H. Frazer is a Fox Point resident and neighborhood contributor as well as the village president. The views expressed are his own and not necessarily those of the Village, the village board, other village board members, or Best Version Media, LLC.*



**Care in the Comfort of Your Home**

*All client care is managed and monitored by Registered Nurses  
We can help from 1 hour/day to 24/7 - including Live-In Care*

Owners  
Tim Bireley  
Laura Bireley, RN





### Areas of Expertise

**Home Care**

- Alzheimer's care, Dementia care, Meal preparation, Laundry, Personal Hygiene, Dressing, Light housekeeping, Transportation, and Companionship - *from 1 hour/day to 24/7 care*

**Skilled Nursing**

- Medication management, Care management, Wound care, Injections, Nursing Assessments, Ostomy/Colostomy care, Catheter management, Vital sign monitoring

**Call today for a free in-home no-obligation consultation! 262-365-1443**

**Home Helpers of Greater Milwaukee**  
[Info@HomeHelpersWI.com](mailto:Info@HomeHelpersWI.com)    [www.HomeHelpersWI.com](http://www.HomeHelpersWI.com)  
 Each Home Helpers is independently owned and operated

9

FOX POINT of View